

COSSES POUR CIRCUIT IMPRIMÉ Laiton et Acier

Traitement de surface standard : Sn Pb 60/40 3 à 5 μ sous-couche CU ou Ni 2 μ

Cosses pour C.I. — 5 x 0,8 (NF C 20 120)

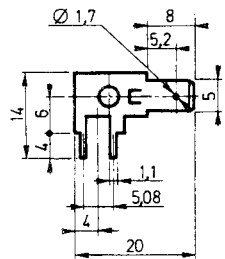

Réf. Y 301 L - Y 301 A

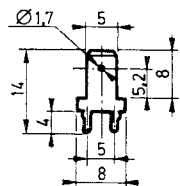

Ø perçage du C.I. : 1,5

Réf. Y 324 L - Y 324 A

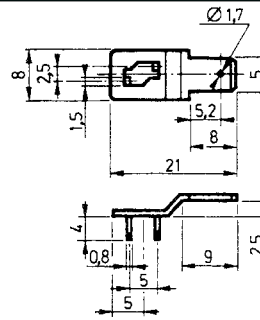

Réf. Y 322 L - Y 322 A

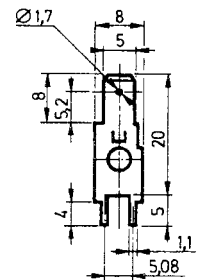

Réf. Y 303 L - Y 303 A

Cosses pour C.I. — 6,3 x 0,8 (NF C 20 120)

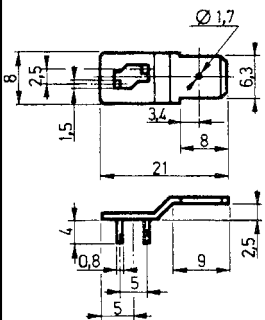

Réf. Y 323 L - Y 323 A

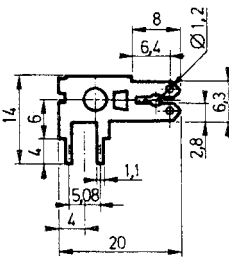

Réf. Y 331 L - Y 331 A

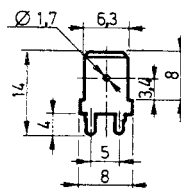

Ø perçage du C.I. : 1,5

Réf. Y 320 L - Y 320 A

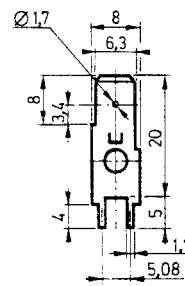

Réf. Y 304 L - Y 304 A

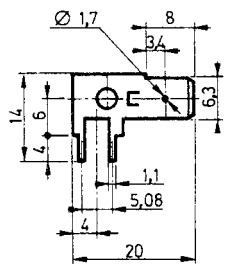

Réf. Y 298 L - Y 298 A

Cosses pour C.I. — 2,8 x 0,5 (NF C 20 120)

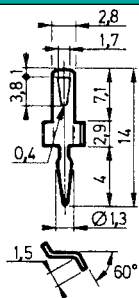

Réf. Y 206 L

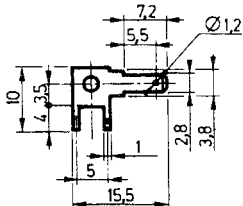

Réf. Y 306 L - Y 306 A

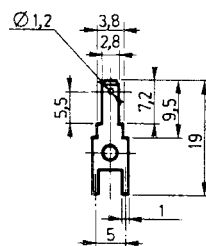

Réf. Y 307 L - Y 307 A

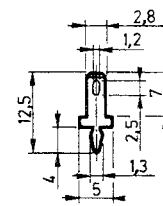

Réf. Y 71 L - Y 71 A

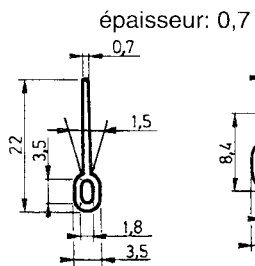

Réf. Y 180 L

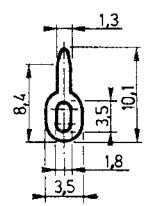

Réf. Y 187 L

Cosses pour C.I. — 2,8 x 0,8 (NF C 20 120)

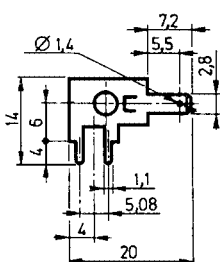

Réf. Y 299 L - Y 299 A

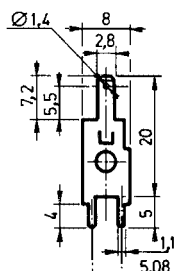

Réf. Y 302 L - Y 302 A

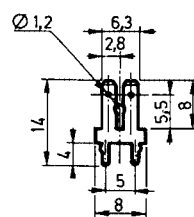

Ø perçage C.I. : 1,5

Réf. Y 319 L - Y 319 A

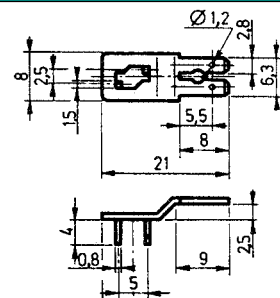

Réf. Y 321 L - Y 321 A